

L-4116 OLD BOG RD

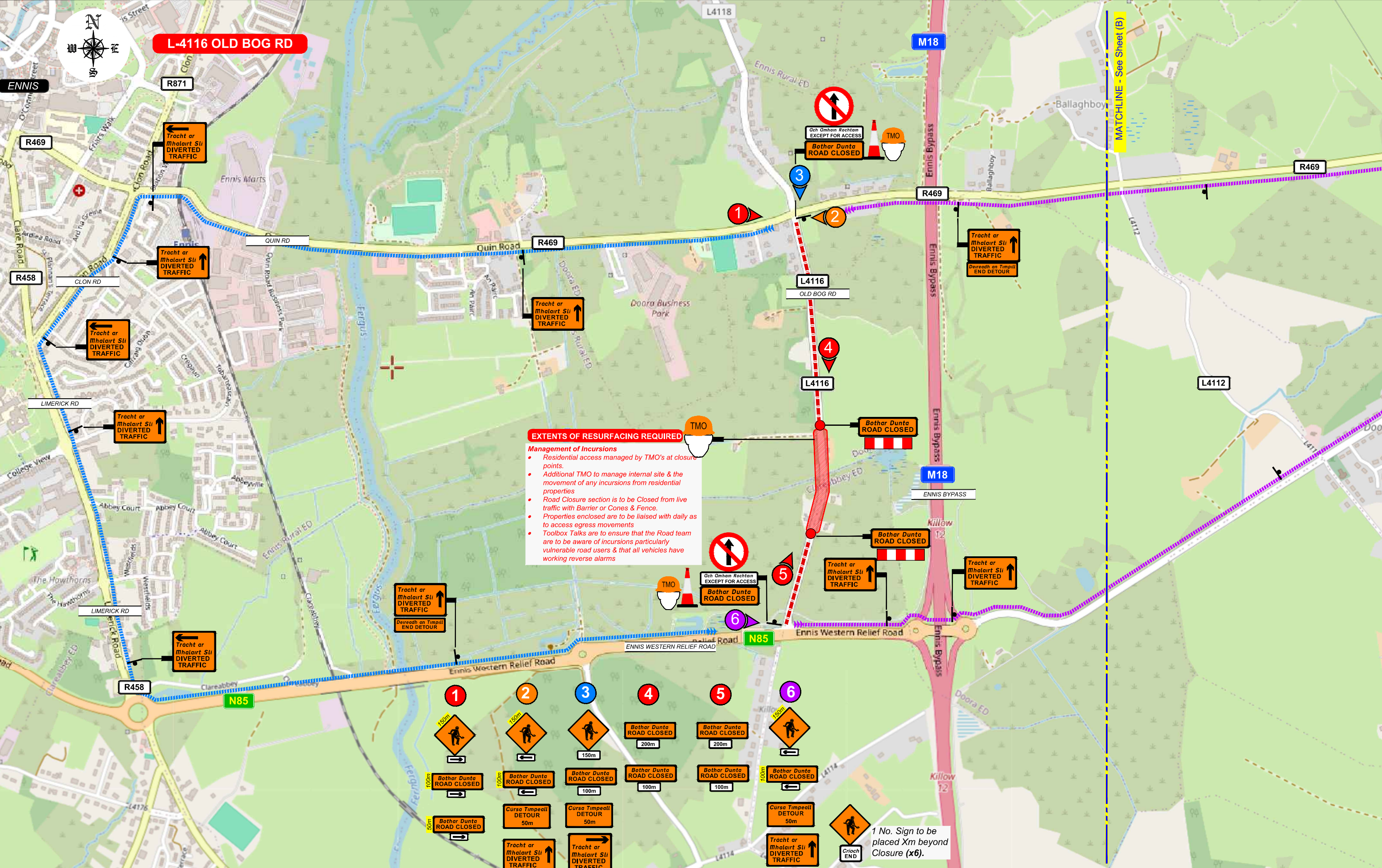

EXTENTS OF RESURFACING REQUIRED

- Management of Incursions**
- Residential access managed by TMO's at closure points
 - Additional TMO to manage internal site & the movement of any incursions from residential properties
 - Road Closure section is to be Closed from live traffic with Barrier or Cones & Fence.
 - Properties enclosed are to be liaised with daily as to access egress movements
 - Toolbox Talks are to ensure that the Road team are to be aware of incursions particularly vulnerable road users & that all vehicles have working reverse alarms

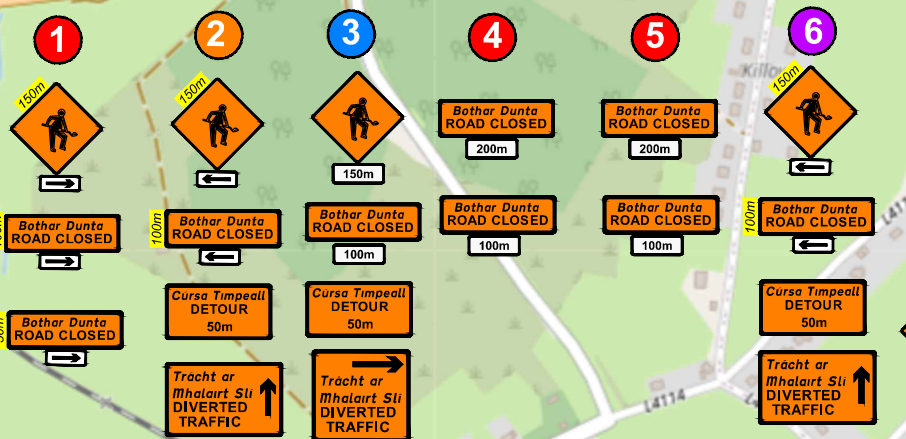

1 No. Sign to be placed Xm beyond Closure (x6).

Stat	Description	Date	Rev	By	Date
RS	Changes as per P.G (TLI)	20/05/24	1	EK	20/05/24
RS	Design issue for COMMENT or APPROVAL	09/05/24			
Stat	Purpose of Issue	Date	Rev	Description	By

EQUIPMENT REQ'D	QTY
SIGNS	0
CONES	0
FED TAPE	0m
SITE FENCE	0m
LAMPS (If Req)	0
MASSGUARD	0m
DELTA BLOC	0m



Traffic Management Design Ltd,
 Unit 13, Newcourt Shopping Centre,
 Church Street, Cavan Town,
 Co. Cavan, Ireland.
 Tel: +353 (0) 49 4327588
 Mob: +353 (0) 86 0442650
 Web: www.trafficmanagementdesignltd.com
 E-mail: roisino@tmdesign.ie

Designed:	EK
Drawn:	EK
Checked:	ROR
Approved:	AV
CAD File:	24 Q007 Rev0.dwg
Scale:	AS SHOWN @A3
Date:	09/05/2024

Client:	TLI GROUP	Job No:	24.022
Project Title:	TIERMACLANE DA	Drawing No:	24 Q007a
Drawing Title:	TEMPORARY TRAFFIC MANAGEMENT LAYOUT FOR DETOUR TO FACILITATE TRENCHING WORKS - L-4116 Old Bog Road, Ennis, Co Clare- SHEET 1 OF 2		
Rev:			1



L-4116 OLD BOG RD

LEGEND

- Resurfacing Extents
- Detour Routes
- Local Access Area
- Sign Symbol

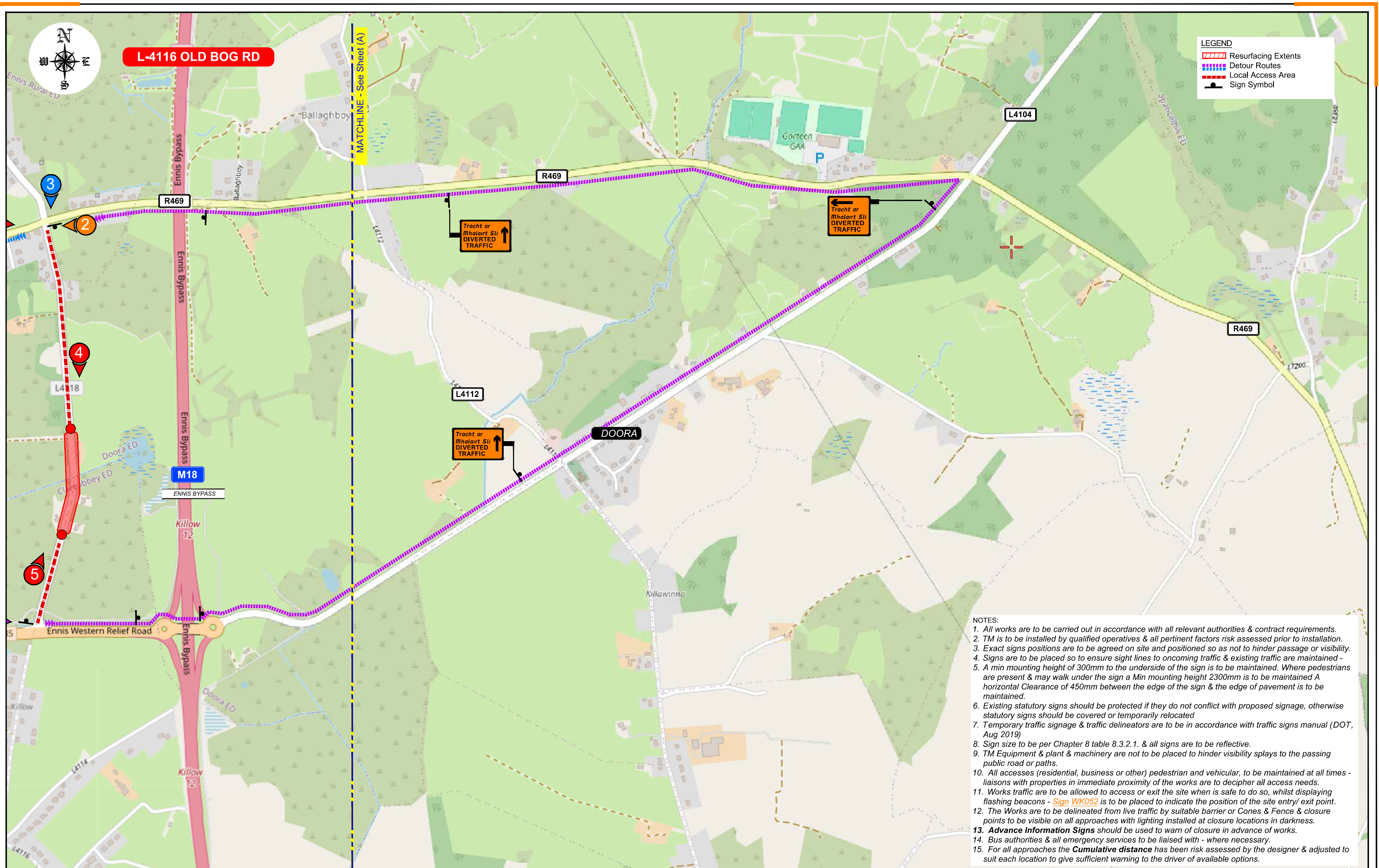

- NOTES:**
1. All works are to be carried out in accordance with all relevant authorities & contract requirements.
 2. TM is to be installed by qualified operatives & all pertinent factors risk assessed prior to installation.
 3. Exact signs positions are to be agreed on site and positioned so as not to hinder passage or visibility.
 4. Signs are to be placed so to ensure sight lines to oncoming traffic & existing traffic are maintained -
 5. A min mounting height of 300mm to the underside of the sign is to be maintained. Where pedestrians are present & may walk under the sign a Min mounting height 2300mm is to be maintained A horizontal Clearance of 450mm between the edge of the sign & the edge of pavement is to be maintained.
 6. Existing statutory signs should be protected if they do not conflict with proposed signage, otherwise statutory signs should be covered or temporarily relocated
 7. Temporary traffic signage & traffic delineators are to be in accordance with traffic signs manual (DOT, Aug 2019)
 8. Sign size to be per Chapter 8 table 8.3.2.1. & all signs are to be reflective.
 9. TM Equipment & plant & machinery are not to be placed to hinder visibility splay to the passing public road or paths.
 10. All accesses (residential, business or other) pedestrian and vehicular, to be maintained at all times - liaisons with properties in immediate proximity of the works are to decipher all access needs.
 11. Works traffic are to be allowed to access or exit the site when is safe to do so, whilst displaying flashing beacons - Sign WK052 is to be placed to indicate the position of the site entry/ exit point.
 12. The Works are to be delineated from live traffic by suitable barrier or Cones & Fence & closure points to be visible on all approaches with lighting installed at closure locations in darkness.
 13. **Advance Information Signs** should be used to warn of closure in advance of works.
 14. Bus authorities & all emergency services to be liaised with - where necessary.
 15. For all approaches the **Cumulative distance** has been risk assessed by the designer & adjusted to suit each location to give sufficient warning to the driver of available options.

RS	Changes as per P.C (TU)	20/05/24	1	Diversion route amended through Doorra Village	EK	20/05/24
RS	Design issue for COMMENT or APPROVAL	09/05/24				
Stat	Purpose of Issue	Date	Rev	Description	By	Date

EQUIPMENT REQ'D	QTY
SIGNS	0
CONES	0
PED TAPE	0m
SITE FENCE	0m
LAMPS (If Req)	0
MASSGUARD	0m
DELTA BLOC	0m



Traffic Management Design Ltd,
 Unit 13, Newcourt Shopping Centre,
 Church Street, Cavan Town,
 Co. Cavan, Ireland.
 Tel: +353 (0) 49 4327588
 Mob: +353 (0) 86 0442650
 Web: www.trafficmanagementdesignltd.com
 E-mail: roisino@tmdesign.ie

Designed:	EK
Drawn:	EK
Checked:	ROR
Approved:	AV
CAD File:	24 Q007 Rev0.dwg
Scale:	AS SHOWN @A3
Date:	09/05/2024

Client:	TLI GROUP	Job No:	24.022
Project Title:	TIERMACLANE DA	Drawing No:	24 Q007b
Drawing Title:	TEMPORARY TRAFFIC MANAGEMENT LAYOUT FOR DETOUR TO FACILITATE TRENCHING WORKS - L-4116 Old Bog Road, Ennis, Co Clare- SHEET 2 OF 2	Rev:	1